

MEMOPOWER PLUS RT II SERIES

1~3kVA
1:1 phase PF: 0.9



Features

- Rack/Tower Convertible Design
- Patented Mimic LCD Display May be Rotated by Simply Pushing Front Button
- True Online Double Conversion
- High Output Power Factor at 0.9PF
- Comprehensive display allows easy monitoring and access of UPS status
- Smart SNMP works with either USB or RS-232 together
- Hot-Swappable Battery
- Efficiency up to 90%
- Estimated Remaining Time displayed on the LCD
- Support Economic(ECO) Operation Mode
- Matching Battery Pack
- Optional Powerful Charger
- Cold Start
- Power Shedding May Turn Off Uncritical Load in Battery Backup
- Emergency Power Off
- Frequency Converter Mode Is Settable



Two directions LCD display



Optional socket



Mini dry contact card



Multifunctional bracket



Rack-Tower convertible



Battery Cabinets (Optional)

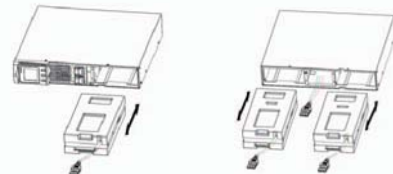
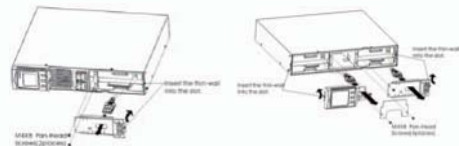

Easy for maintenance, hot-swappable battery

Technical Specifications:

MODEL	MP S RT2 1KVA	MP S RT2 1.5KVA	MP S RT 2KVA	MP S RT 3KVA	
Capacity(VA/Watts)	1000/900	1500/1350	2000/1800	3000/2700	
INPUT					
Rated Voltage	200/208/220/230/240Vac				
Voltage Range	110~290Vac				
Frequency Range	45~65Hz(auto-detect)				
Power Factor	≥0.98				
Bypass Voltage Range	Max.voltage: +15%(optional +5%、+10%、+25%) Min. voltage: -45% (optional-15% -20%、-30%) Frequency protection range: ± 10%				
Generator Input	Support				
OUTPUT					
Rated Voltage	200/208/220/230/240Vac				
Power Factor	0.9				
Voltage Regulation	± 2%				
Frequency	Utility Mode	50Hz or 60Hz(Synchronized to Mains)			
	Battery Mode	50/60Hz ± 0.02Hz			
Crest Factor	3:1				
THDv	≤3% with linear load				
	≤5% with non linear load				
Efficiency	AC Mode(full load)	up to 90%			
	Battery Mode(full load)	>85%			
	ECO Mode(full load)	>94%			
BATTERY					
Standard Model	Battery Type	12V/9AH	12V/9AH	12V/9AH	12V/9AH
	Numbers	2	3	4	6
	Typical Recharge Time	4 hours recover to 90% capacity			
	Charging Current(max.)	1.4A			
	Charging Voltage	27.4Vdc ± 1%	41.0Vdc ± 1%	54.7Vdc ± 1%	82.1Vdc ± 1%
Long-run Model	Battery Numbers	Depending on the capacity of external batteries			
	Charging Current(max.)	6A/12A(double board)	7A/14A(double board)	6A/12A(double board)	6A/12A(double board)
	Charging Voltage	27.4Vdc ± 1%	41.0Vdc ± 1%	54.7Vdc ± 1%	82.1Vdc ± 1%
SYSTEM FEATURES					
Transfer time	Utility to Battery : 0ms; Utility to bypass< 4ms				
Overload	AC Mode	Load <100%~150%: 30S; Load > 150%: 300ms then shut down UPS completely			
	Bat. Mode	Load <100%~150%: 30S; Load > 150%: 300ms then shut down UPS completely			
	Bypass Mode	Load > 130%: 60S then shut down output			
Audible & Visual	Line Failure, Battery Low, Overload, System Fault				
Status LED & LCD	Load/Battery/Input/Output/Operating Mode Information				
ENVIRONMENTAL					
Dimension(W × H × D)mm	440 × 86.5 × 430	440 × 86.5 × 430	440 × 86.5 × 572	440 × 86.5 × 696	
Weight (Kg)	15.1	18.1	22.2	25.5	
Input Connection	IEC320 C14-10A	IEC320 C14-10A	IEC320 C20-16A	IEC320-C20-16A	
Output Connection	IEC320 C13-10A × 6	IEC320 C13-10A × 6	IEC320 C13-10A × 6	IEC320 C13-10A × 6 & C19-16A × 1	
Communication Interface	Smart RS232/USB Port/RJ45/SNMP Card (independent to RS232)				
Operating Temperature	0 ~ 40℃				
Storage Temperature	-25 ~ +55℃				
Humidity	0 ~ 90% (non condensing)				
Altitude	<1500m.(derating while > 1500m)				
Noise	<50dB(at 1 meter)				
BATTERY BANK					
Model	RTII-BR04009	RTII-BR06009	RTII-BR08009	RTII-BR12009	
Bat.Type&Max.Quantity	9AH × 4	9AH × 6	9AH × 8	9AH × 12	
PHYSICAL OF BATTERY BANK					
Unit Dimensions W × H × D (mm)	440 × 86.5 × 430	440 × 86.5 × 430	440 × 86.5 × 572	440 × 86.5 × 696	
Weight (Kg)	12	15	22	32	

Specifications are subject to change without prior notice.